

LIGHT RING SOLUTION

SHUFFLE is a connected, modular approach to city hardware - with its plug-and-play rotatable modules that contain pre-certified hardware, it can be configured to suit your specific needs.

KEY ADVANTAGES

- **Seamless integration in the SHUFFLE column**
- **Signage / beautification (identity) / creation of ambiance**
- **Red, blue, green, warm or neutral white LEDs**
- **1 or 2 alternating colours**



The SHUFFLE Light Ring module adds a decorative touch and light signal option to the column. It is designed for cities to enhance a public event or location or even interact with other modules in the SHUFFLE like an EV charging or intercom solution.

Different LED colours are available: white, red, green and blue.

The SHUFFLE LIGHT RING also offers different behaviour like changing colours. It can switch colour after pushing the Intercom to signal an emergency or it can change colour to indicate if an EV charger is being used or is free.

Modules are in high-pressure, die-cast aluminium and a protector in opal PC is used to protect the LEDs and interior components. All fasteners are in stainless steel. Polyester powder painting in a variety of colours is possible to offer the customer endless possibilities.



LIGHT RING | CHARACTERISTICS

KEY FEATURES

- > **Signage / information**
- > **Can inform, warn or guide a crowd through colour**
- > **EV charger: free/in-use**
- > **Intercom: emergency yes/no**

DIMENSIONS AND MOUNTING

AxBxC (mm inch)	194x215x194 7.6x8.5x7.6
Weight (kg lbs)	4 8.8
Aerodynamic resistance (CxS)	0.038
Mounting possibilities	Clamps

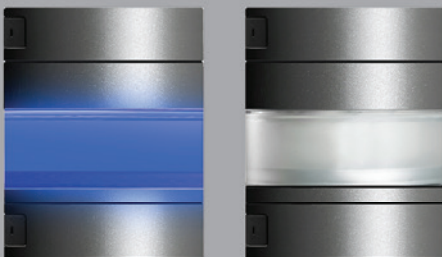
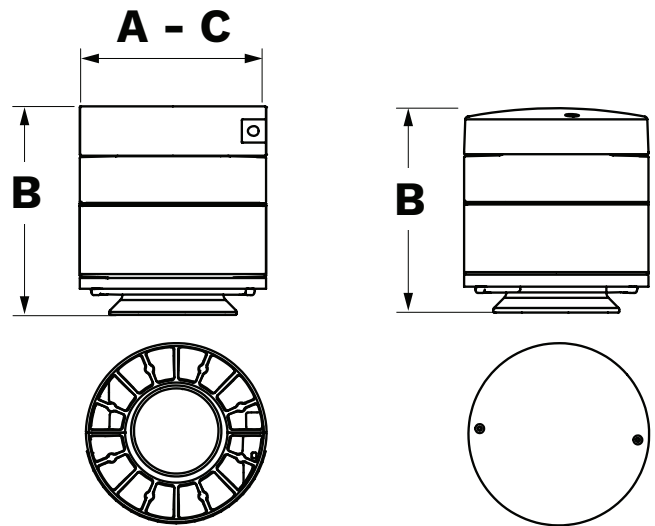

LIGHT RING | CHARACTERISTICS

GENERAL

Recommended installation height	2.3m to 6.8m 7.5' to 22.3'
CE mark	Yes
CB mark	Yes (Gen 1)
ROHS compliant	Yes

HOUSING AND FINISH

Housing	Aluminum
Protector	Polycarbonate
Housing finish	Polyester powder coating
Standard colour	AKZO grey 900 sanded
Tightness level	IP 66
Impact resistance	IK 09

SHUFFLE

SHUFFLE Pole models	1 door 2 doors same side 2 doors opposite 3 doors
SHUFFLE Components	Mains box Lighting Box Beyond Light Power Supply Box
Position on pole	Any position - maximum 2 modules above
Module Interaction	can be linked to Intercom or EV Charger

ELECTRICAL

Electrical class	Class I EU, Class II EU Class I US (Gen 1)
Nominal voltage	220-240V 50/60Hz 120V -277V 50/60Hz (Gen 1)
Surge protection options (kV)	10
Power consumption	max 5.6W

OPTICAL INFORMATION

LED colour temperature	3000K (Warm White 830) 4000K (Neutral White 740) Red Green Blue
Color rendering index (CRI)	>80 (Warm White 830) >70 (Neutral White 740)

LIGHT RING MODES

Powered by Lighting Box, 1 steady colour
Powered by beyond lighting grid (whole day), 2 steady colours alternating, depending 12V DC signal (with EV-charger)
Powered by beyond lighting grid (whole day), 1 colour on/off, alternating depending 24V DC signal (with intercom)
Powered by beyond lighting grid (whole day), 2 steady colours, alternating depending 24V DC signal (with intercom)